



**STABILPLASTIC SPA**

# STABILENE MULTISTRATO



Listino prezzi  
10/2024

Tubi e raccordi di Polipropilene autoestinguente  
a norma UNI EN 1451-1



## HTEM

Tubo stabilene con un bicchiere

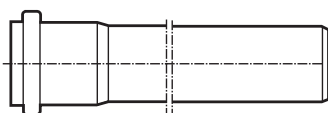

Diametro Ø	Lunghezza mm.	Prezzo cad. €	Imballo
32	150	1,79	10
32	250	2,00	10
32	500	3,14	30
32	1000	5,08	30
32	1500	7,12	30
32	2000	9,48	30
32	3000	10,45	30
40	250	1,70	20
40	500	2,53	30
40	1000	4,19	30
40	1500	5,87	30
40	2000	8,01	30
40	3000	11,61	30
50	250	2,07	20
50	500	3,08	30
50	1000	5,15	30
50	1500	8,94	30
50	2000	10,12	30
50	3000	14,94	30
75	150	2,53	20
75	250	3,10	20
75	500	4,49	20
75	750	6,45	20
75	1000	7,52	20
75	1500	12,77	20
75	2000	14,19	20
75	3000	20,03	20
90	150	3,58	20
90	250	4,60	20
90	500	7,47	8
90	1000	12,66	8
90	1500	18,09	8
90	2000	25,77	8
90	3000	39,43	8
110	250	5,15	20
110	500	8,46	4
110	750	11,77	4
110	1000	14,27	4
110	1500	20,45	4
110	2000	29,20	4
110	3000	44,61	4
125	250	10,51	10
125	500	13,70	4
125	1000	24,80	4
125	1500	34,17	4

125	2000	44,61	4
125	3000	63,49	4
◆ 160	250	22,85	5
◆ 160	500	28,77	4
◆ 160	1000	42,72	4
◆ 160	1500	59,52	4
◆ 160	2000	77,16	4
◆ 160	3000	112,44	4



## HTDM

Tubo stabilene con due bicchieri

Diametro Ø	Lunghezza mm.	Prezzo cad. €	Imballo
32	500	5,15	30
32	1000	5,75	30
32	1500	8,98	35
32	2000	10,96	30
32	3000	14,57	30
40	500	3,22	30
40	1000	4,78	30
40	1500	7,40	30
40	2000	8,67	30
40	3000	12,79	30
50	500	3,90	30
50	1000	5,75	30
50	1500	9,36	30
50	2000	11,43	30
50	3000	16,61	30
75	500	6,06	20
75	1000	9,32	20
75	1500	13,40	20
75	2000	17,09	20
75	3000	24,96	20
90	500	9,58	8
90	1000	14,39	8
90	1500	21,55	8
90	2000	29,36	8
90	3000	44,90	8
110	500	10,78	4
110	1000	17,74	4
110	1500	24,30	4
110	2000	30,13	4
110	3000	46,57	4
125	500	18,83	4
125	1000	28,71	4
125	1500	38,54	4
125	2000	55,12	4
125	3000	85,27	4

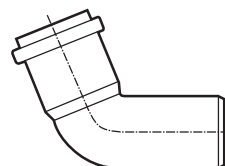

## HTB Curva

Diametro Ø	Gradi	Prezzo cad. €	Imballo
32	15°	1,85	20
32	30°	1,85	20
32	45°	1,85	40
32	67,5°	1,85	20
32	87,5°	1,85	40
40	15°	1,41	40
40	30°	1,41	40
40	45°	1,41	60
40	67,5°	1,41	40
40	87,5°	1,41	60
50	15°	1,72	20
50	30°	1,72	20
50	45°	1,72	40
50	67,5°	1,72	20
50	87,5°	1,72	40
75	15°	3,10	20
75	30°	3,10	20
75	45°	3,10	20
75	67,5°	3,10	20
75	87,5°	3,10	20
90	15°	4,88	20
90	30°	4,88	20
90	45°	4,88	20
90	67,5°	4,88	20
90	87,5°	4,88	20
110	15°	5,45	20
110	30°	5,45	20
110	45°	5,45	30
110	67,5°	5,45	20
110	87,5°	5,45	20
125	15°	14,11	20
125	30°	14,11	20
125	45°	14,11	20
125	67,5°	14,11	20
125	87,5°	14,11	20
◆ 160	15°	32,71	10
◆ 160	30°	32,71	10
◆ 160	45°	32,71	10
◆ 160	87,5	39,55	10

# Tubi\* e raccordi di polipropilene autoestinguente con anelli di giunzione incorporati, conforme a norma UNI EN 1451-1

\*I tubi sono di colore: esterno grigio, interno bianco. I raccordi sono di colore grigio.

## HTEA Braga

Diametro Ø	Gradi	Prezzo cad. €	Imballo
32 / 32	45°	3,80	20
32 / 32	87,5°	4,70	20
40 / 32	45°	4,14	20
40 / 32	67,5°	4,14	10
40 / 40	45°	2,75	40
40 / 40	67,5°	2,75	20
40 / 40	87,5°	2,75	20
50 / 40	45°	3,08	20
50 / 40	67,5°	3,50	20
50 / 40	87,5°	3,08	20
50 / 50	45°	3,43	20
50 / 50	67,5°	3,43	20
50 / 50	87,5°	3,43	20
75 / 40	45°	5,38	20
75 / 40	67,5°	5,38	20
75 / 40	87,5°	5,38	20
75 / 50	45°	5,54	20
75 / 50	67,5°	5,54	20
75 / 50	87,5°	5,54	20
75 / 75	45°	6,32	20
75 / 75	67,5°	6,32	20
75 / 75	87,5°	6,32	20
90 / 40	45°	5,92	15
90 / 40	87,5°	5,92	15
90 / 50	45°	5,93	15
90 / 50	87,5°	5,93	15
90 / 90	45°	9,24	15
90 / 90	87,5°	9,24	15
110 / 40	45°	6,67	20
110 / 40	67,5°	6,67	20
110 / 40	87,5°	6,67	20
110 / 50	45°	6,79	20
110 / 50	67,5°	6,79	20
110 / 50	87,5°	6,79	20
110 / 75	45°	9,73	20
110 / 75	67,5°	9,73	20
110 / 75	87,5°	9,73	20
110 / 110	45°	10,23	20
110 / 110	67,5°	10,23	20
110 / 110	87,5°	10,23	20
125 / 110	45°	34,66	10
125 / 110	67,5°	34,66	10
125 / 110	87,5°	34,66	10
125 / 125	45°	43,41	5
125 / 125	67,5°	43,41	10
125 / 125	87,5°	43,41	10
◆ 160 / 110	45°	92,65	10
◆ 160 / 110	67,5°	92,65	8
◆ 160 / 110	87,5°	92,65	10
◆ 160 / 125	45°	119,69	10
◆ 160 / 125	87,5°	139,66	10
◆ 160 / 160	45°	142,76	10
◆ 160 / 160	87,5°	189,08	10

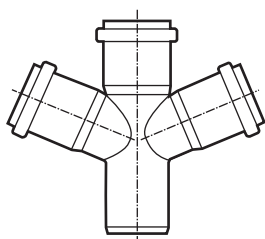
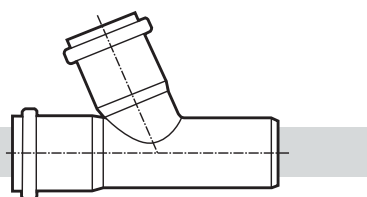

## HTDA Braga doppia

Diametro Ø	Gradi	Prezzo cad. €	Imballo
50/50/50	67,5°	12,96	20
90/40/40	45°	20,59	10
90/50/50	45°	20,59	10
110/40/40	45°	9,89	20
110/50/50	67,5°	16,01	20
110/110/110	67,5°	19,20	10

## HTM Tappo

Diametro Ø	Prezzo cad. €	Imballo
40	0,83	20
50	1,13	20
75	1,79	20
90	2,83	20
110	3,11	20
125	7,24	20

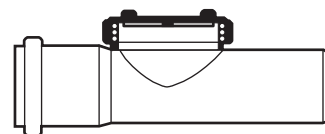

## HTRE Ispezione

Diametro Ø	Prezzo cad. €	Imballo
50	6,39	20
75	8,13	20
90	10,74	20
110	11,74	20
125	56,78	5
◆ 160	83,10	10

## HTU Manicotto

Diametro Ø	Prezzo cad. €	Imballo
32	2,22	20
40	2,09	20
50	2,78	20
75	3,89	20
90	5,80	20
110	6,45	20
125	15,42	20
◆ 160	31,36	15

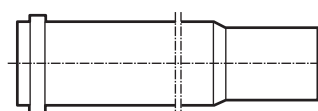
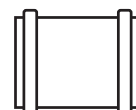

## HTLL Bicchiere doppia profondità

Diametro Ø	Prezzo cad. €	Imballo
40	6,49	20
50	6,90	20
75	8,55	20
90	10,66	20
110	11,89	20

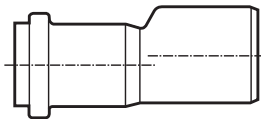

## HTR

Riduzione

Diametro Ø	Prezzo cad. €	Imballo
40 / 32	2,38	20
50 / 32	2,61	20
50 / 40	1,65	20
75 / 40	2,78	20
90 / 40	4,49	20
75 / 50	3,06	20
90 / 50	4,60	20
110 / 50	4,44	20
90 / 75	4,66	20
110 / 75	5,19	20
110 / 90	5,04	20
125 / 110	12,36	20
◆ 160 / 110	22,44	20
◆ 160 / 125	31,56	20

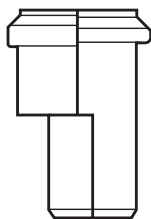

## RE

Riduzione eccentrica

Diametro Ø	Prezzo cad. €	Imballo
50 / 40	4,73	20

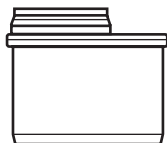

## HTRI

Riduzione eccentrica ad incasso

Diametro Ø	Prezzo cad. €	Imballo
50 x 40	2,57	20
90 x 40	4,85	20
90 x 50	5,08	20
110 x 50	5,51	20
110 x 90	6,25	20

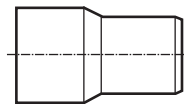

## HTS

Raccordo per giunzione tubo metallo con guarnizione

Diametro Ø	Prezzo cad. €	Imballo
32x1"e1 <sup>1</sup> / <sub>4</sub> "	2,77	20
40x1"e1 <sup>1</sup> / <sub>4</sub> "	2,45	20
☐ 50x1"	3,31	20
☐ 50x1"e1 <sup>1</sup> / <sub>4</sub> "	3,31	20
☐ 50x1"e1 <sup>1</sup> / <sub>2</sub> "	3,31	20

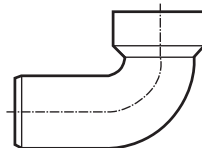

## HTSW

Curva per sifoni con guarnizione

Diametro Ø	Prezzo cad. €	Imballo
32x1"e1 <sup>1</sup> / <sub>4</sub> "	2,77	20
40x1 <sup>1</sup> / <sub>4</sub> "	2,60	40
☐ 50x1"	2,80	20
☐ 50x1 <sup>1</sup> / <sub>4</sub> "	2,80	20
☐ 50x1 <sup>1</sup> / <sub>2</sub> "	2,80	20

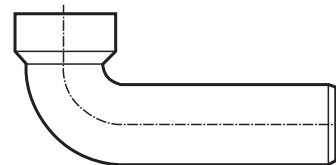

## HTSW-P

Curva per sifone prolungata

Diametro Ø	Prezzo cad. €	Imballo
40x1"e1 <sup>1</sup> / <sub>4</sub> "	1,82	40



## GHT

Guarnizione per HTSW • HTS • HTSW-P

Diametro Ø	Tubo metallo	Prezzo cad. €	Imballo
40x1e <sup>1</sup> / <sub>2</sub> "	28-34	1,40	20
40x1 <sup>1</sup> / <sub>4</sub> "	38-44	1,40	20
50x1"	28-34	1,51	20
50x1 <sup>1</sup> / <sub>4</sub> "	38-44	1,51	20
50x1 <sup>1</sup> / <sub>2</sub> "	48-54	1,51	20



## Guarnizione tra tubo e raccordo con bicchiere tipo stabilene e stabil HT302 per giunzione con tubo di metallo

Diametro Ø	Tubo metallo	Prezzo cad. €	Imballo
40/A	26-28	3,50	20
40/B	30-32	3,50	20
50/C	30-32	3,65	20
50/D	38-40	3,65	20

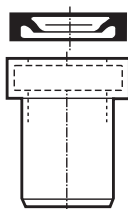

## HTSK

Raccordo WC con guarnizione

Diametro Ø	Lunghezza mm.	Prezzo cad. €	Imballo
90 / 90	300	17,46	10
110 / 110	230	18,41	10

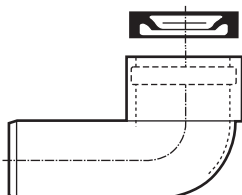

## HTSB-A

Curva WC alta con guarnizione

Diametro Ø	Gradi	Prezzo cad. €	Imballo
90/90	90°	15,12	20
110/110	90°	16,73	10

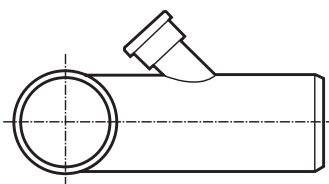

## HTSB-A-S-40

## HTSB-A-S-50

Curva WC alta sinistra con guarnizione con attacco Ø 40 o Ø 50

Diametro Ø	Gradi	Prezzo cad. €	Imballo
90 / 40	45°	19,64	10
110 / 40	45°	21,88	10
90 / 50	45°	20,25	10
110 / 50	45°	22,72	10

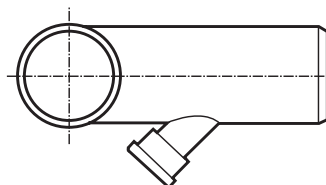

## HTSB-A-D-40

## HTSB-A-D-50

Curva WC alta destra con guarnizione con attacco Ø 40 o Ø 50

Diametro Ø	Gradi	Prezzo cad. €	Imballo
90 / 40	45°	19,64	10
110 / 40	45°	21,98	10
90 / 50	45°	20,25	10
110 / 50	45°	22,72	10

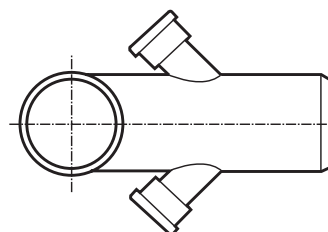

## HTSB-A-Do-40

## HTSB-A-Do-50

Curva WC alta doppia con guarnizione con due attacchi Ø 40 o Ø 50

Diametro Ø	Gradi	Prezzo cad. €	Imballo
90 / 40	45°	22,64	10
110 / 40	45°	24,95	10
90 / 50	45°	23,21	10
110 / 50	45°	25,70	10

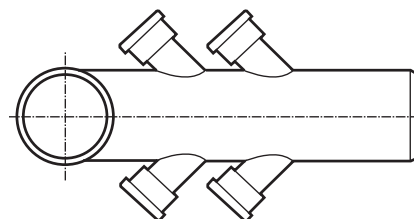

## HTSB-A-4A-40

## HTSB-A-4A-50

Curva WC alta con guarnizione con quattro attacchi Ø 40 o Ø 50

Diametro Ø	Gradi	Prezzo cad. €	Imballo
110 / 40	45°	39,34	5
110 / 50	45°	40,50	5

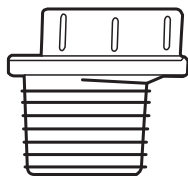

**MAMO**  
Manicotto morbido  
concentrico ed eccentrico  
per vasi

Diametro Ø	Prezzo cad. €	Imballo
110	10,48	10



**GA** Guarnizione  
per curva WC alta

Diametro Ø	Prezzo cad. €	Imballo
110	4,27	10



**OR**  
Anelli a labbro

Diametro Ø	Prezzo cad. €	Imballo
32	0,57	20
40	0,68	20
50	0,71	20
75	0,83	20
90	1,14	20
110	1,20	20
125	1,72	20
160	1,82	20



**ST**  
Scivolante

Gr.	Prezzo cad. €	Imballo
250	7,70	50



**FI**  
Sifone firenze orizzontale  
in Polipropilene

Diametro Ø	Prezzo cad. €	Imballo
75	57,00	1
90	62,23	1
110	67,46	1
125	71,01	1
160	122,96	1
200	204,37	1

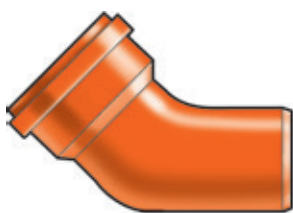

**CR**  
Curva ridotta in PVC

Diametro Ø	Gradi	Prezzo cad. €	Imballo
110 / 100	15°	<b>12,12</b>	10
110 / 100	30°	<b>12,12</b>	10
110 / 100	45°	<b>12,12</b>	10
110 / 100	67°50'	<b>13,69</b>	10
110 / 100	87°50'	<b>13,69</b>	10

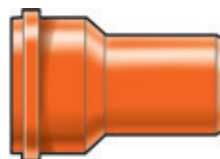

**TR**  
Tronchetto ridotto in PVC

Diametro Ø	Prezzo cad. €	Imballo
110 / 100	<b>12,28</b>	10



**VA**  
Valvola antiriflusso in PVC

Diametro Ø	Prezzo cad. €	Imballo
110	<b>305,13</b>	1
125	<b>348,70</b>	1
160	<b>419,55</b>	1
200	<b>488,84</b>	1

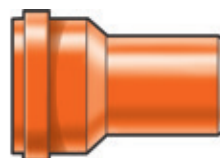

**RP**  
Raccordo di passaggio in PVC da tubo 302 extratubo a tipo stabilene

Diametro Ø	Prezzo cad. €	Imballo
40 / 40	<b>4,49</b>	20
40 / 50	<b>4,97</b>	20
50 / 50	<b>5,09</b>	20
50 / 75	<b>6,40</b>	20
75 / 110	<b>10,26</b>	20
100 / 110	<b>10,26</b>	10
100 / 125	<b>10,60</b>	16
110 / 125	<b>10,60</b>	7
110 / 160	<b>18,05</b>	10
125 / 125	<b>16,68</b>	10
125 / 160	<b>18,05</b>	10
160 / 160	<b>22,70</b>	10



**STABIL PLASTIC SPA**

Un sistema completo per la canalizzazione e la gestione dei fluidi.

# Collegatevi con la nostra rete



FOGNATURE: TUBO STRUTTURALE  
WASTE AND SEWERAGE (STRUCTURED PIPE)



FOGNATURE: TUBO COMPATTO  
WASTE AND SEWERAGE (COMPACT PIPE)



EDILIZIA: PLUVIALI E SCARICHI  
BUILDING: RAINWATER AND DISCHARGES



DRENAGGIO  
DRAINAGE



CAVIDOTTI  
CONDUITS PIPES



Strada statale 341, n°24 - 21015 Lonate Pozzolo - (VA) Italia  
tel. ++39 0331 301 733 fax ++39 0331 301 516

[www.stabilplastic.it](http://www.stabilplastic.it) [info@stabilplastic.it](mailto:info@stabilplastic.it)  @ stabilplastic\_spa